

Pursuant to a warrant from John Thomas, Esq. Commissioner of Locations for the 96th District, No. 1 Saluda, I have admeasured and laid out unto James Gordon a tract of five hundred & two acres of land in Laurens County 96th District, on two small branches of Duncanson Creek waters of Enoree river, bounding by a line running S. 8. E. N. E. by land survey for Roland M. Curley, by a line running S. E. by land survey for Hugh Young, all other sides on vacant land, and hath such shape and marks as the above Plat represents.

Witness my hand & seal this 11th day of April 1790,
 Recorded 17th Oct. 1790 Del. G. Hunter

South Carolina, Pursuant to a warrant from John Thomas, Esq. Comr. of loc. in Saluda river Dated 23. Oct. 1790 I have admeasured and laid out unto James Gordon a tract of five hundred & two acres of land in Laurens County 96th District, on two small branches of Duncanson Creek waters of Enoree river, bounding by a line running S. E. & N. E. by land survey for Roland M. Curley, by a line running S. E. by land survey for Hugh Young, all other sides on vacant land, and hath such shape and marks as the above Plat represents.

Witness my hand & seal this 11th day of Nov. 1790, A. Pearson Esq.
 Recorded 16th Nov. 1790, Del. self.



State of S. Carolina, Pursuant to a warrant from John Thomas, Comr. of loc. in Saluda, I have admeasured and laid out unto Alexander McNeely a tract of three hundred and twenty five acres of land on the branches of Duncanson Creek in Laurens County, having such shape, marks, buttresses, and bounding as the above Plat represents.

Witness my hand & seal this 25th day of Oct. 1790,
 Not. Hannah Esq.
 Recorded 16th Nov. 1790, Del. self.

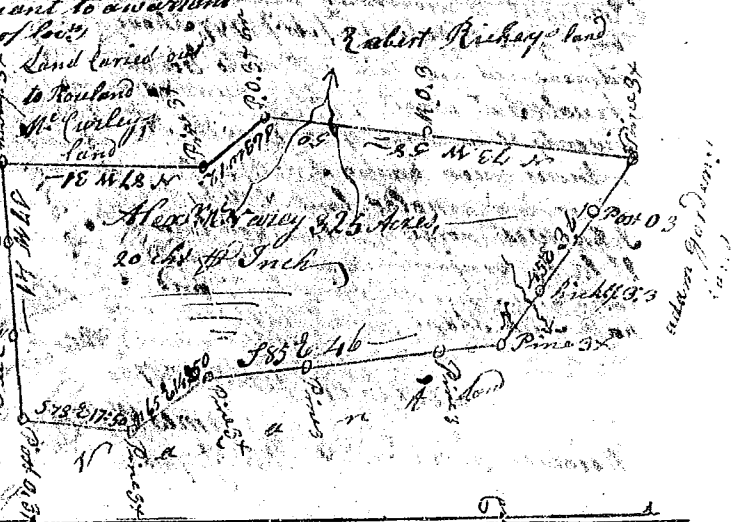

State of S. Carolina, Pursuant to a warrant from John Thomas, Esq. Commissioner of Locations for 96th District No. 1 Saluda, Dated 22. Sept. 1790 I have admeasured and laid out unto Nathaniel Nichols a tract of forty four acres of land in 96th District, Laurens County on Mudlick Creek waters of Saluda river, bounded by a line running S. 71 E. 20 ch. George Hollingsworth's land, N. 3 d. 11 E. 50 N. 38. 1/2 E. 50 on Nathaniel Nichols's land, by a line running N. 6 E. 11 E. 50 on John Edwells land, and hath such shape, form, and marks as the above Plat represents, Certified this 24th Sept. 1790,

Recorded 19th Nov. 1790, Del. Charles Nichol, John Hunter Esq.

